

Patient terminal PAT-E

User manual

Overview

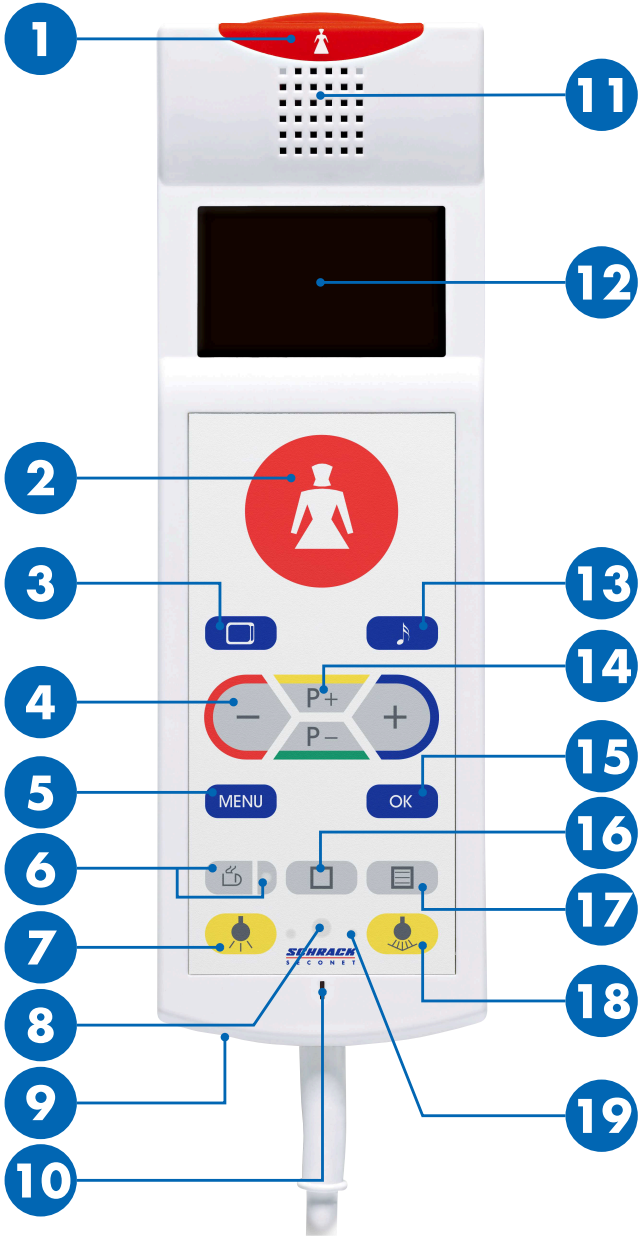

- 1 / 2 Call buttons
- 3 TV button
- 4 -/+ button
- 5 Menu button
- 6 Service call button with LED (finder light)
- 7 Room light
- 8 Infrared receiver (optional)
- 9 Headphone connection
- 10 Microphone
- 11 Loudspeaker
- 12 Display
- 13 Radio button
- 14 Program selection buttons
- 15 Confirmation button
- 16 Special function button
- 17 Teletext button
- 18 Reading light
- 19 LED of light button (finder light)



CAUTION

Do not use as rising aid

Cable and device are no rising aid. Do not pull yourself up using the device.

Operation

Care staff call

The call button  **1** is constantly lit, so that it is easier to locate even in the dark.

Call care staff

Press call button  **1** or **2**.

- ▶ The call button  **1** lights up.

Care staff answers

1. Gong sounds over loudspeaker **11** and the call button flashes.
2. Use the patient terminal like a telephone for the talk with the care staff.
3. The care staff ends the call at the end of the talk.

Service call

The LED of the button is constantly lit, so that it is easier to locate even in the dark.

Press service call button  **6**.

- ▶ The service call button LED  **6** lights up.

The service staff will either call you on the device or will come to you in person.

Turn light on and off

The LED of the light buttons **19** are constantly lit, so that the buttons are easier to locate even in the dark.

Room light (optional)

Press the room light button  **7** briefly.

- ▶ Room light is turned on or off.

Reading light (optional)

Press the reading light button  **18** briefly.

- ▶ Reading light is turned on or off.

Menu functions

Set display brightness

1. Press button **MENU** **5**.
2. Select **Brightness** on the display **12** using the program selection buttons **P+/P-** **14**.
3. Confirm with **OK** button **15**.
4. Set the desired brightness using **-/+** buttons **4**.
5. Using the menu button **MENU** **5** to leave menu.

Set display contrast

1. Press button **MENU** **5**.
2. Select **Contrast** on the display **12** using the program selection buttons **P+/P-** **14**.
3. Confirm with **OK** button **15**.
4. Set the desired contrast using **-/+** buttons **4**.
5. Using the menu button **MENU** **5** to leave menu.

Set volume

1. Press button **MENU** **5**.
2. Select **Volume** on the display **12** using the program selection buttons **P+/P-** **14**.
3. Confirm with **OK** button **15**.
4. Select for which function the volume should be set using the program selection buttons **P+/P-** **14**.
5. Set the desired volume using **-/+** buttons **4**.
6. Using the menu button **MENU** **5** to leave menu.

Optional functions

TV

Turn TV set on and off

Press TV button  3 to turn the TV set on or off.

- ▶ The TV set is turned on and the last channel watched will be indicated on the display 12.

Choosing a channel

Switch to the next channel using the program selection buttons **P+/P-** 14.

Setting sound and volume

Sound output via the loudspeaker 11 or connected headphones (connection socket 9).

Set the desired volume using **-/+** buttons 4.

Call up teletext

1. Press teletext button  17 to call up or leave teletext mode.
2. Switch to the next page using the program selection buttons **P+/P-** 14.

Radio

Turn radio on and off

Press radio button  13 to turn the radio on or off.

- ▶ The radio is turned on and the last radio channel listened to will be indicated on the display 12.

Choosing a channel

Switch to the next channel using the program selection buttons **P+/P-** 14.

Setting sound and volume

Sound output via the loudspeaker 11 or connected headphones (connection socket 9).

Set the desired volume using **-/+** buttons 4.

Blinds control

1. Press special functions button  16.
2. Select **Blinds** on the display 12 using the program selection buttons **P+/P-** 14.
3. Open or close the blinds using the **-/+** buttons 4.

Infrared receiver

The infrared receiver is used to remotely control the patient terminal via environmental control devices.

Schrack Seconet AG

Eibesbrunnnergasse 18 | A-1120 Vienna

+43 50 857 | office@schrack-seconet.com

[schrack-seconet.com](https://www.schrack-seconet.com)

Czech Rep., CZ-149 00 Prague 4, Štřitová 283 | +420 2 74784422

Hungary, HU-1119 Budapest, Fehérvári út 89-95 | +36 1 4644300

India, IN-122102 Gurgaon, C-704A, Pioneer Urban Square, Sec-62 | +91 124 4141501

Poland, PL-02-972 Warsaw, ul. Branickiego 15, Wilanów Office Park, bud. B1 | +48 22 3300620

Romania, RO-023961 București, Str. Mântuleasa nr. 15A/1 | +40 372 756316

Russia, RU-123001 Moscow, B. Sadovaya str. 5, build. 1 office 514 | +7 495 5105015

Slovakia, SK-831 06 Bratislava, Mudrochova 2 | +421 2 44635595

Sweden, SE-126 30 Hägersten, Vretenborgsvägen 28, Floor 9 | +46 8 6801860

Turkey, TR-34718 Kadıköy-İstanbul, Koşuyolu Mah. İsmailpaşa Sk.No: 78 | +90 216 3455199